

veritas®

Router Table Insert Plate

Assembly Instructions

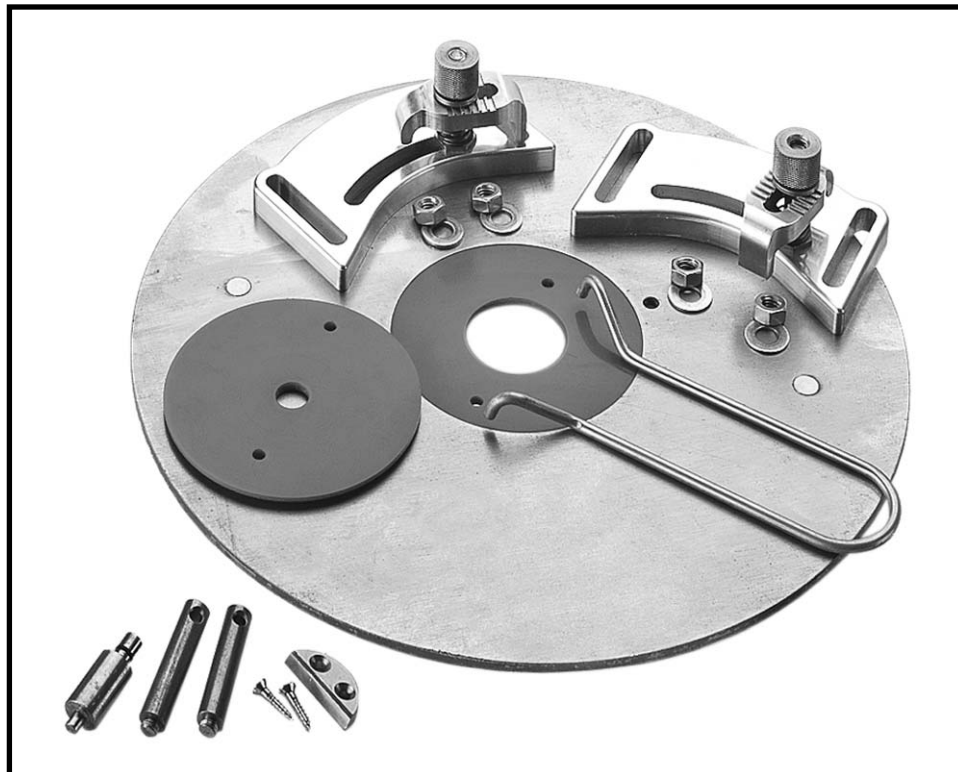

05J38.02

U.S. Patent No. 5,715,880
U.K. Patent No. 2,309,664

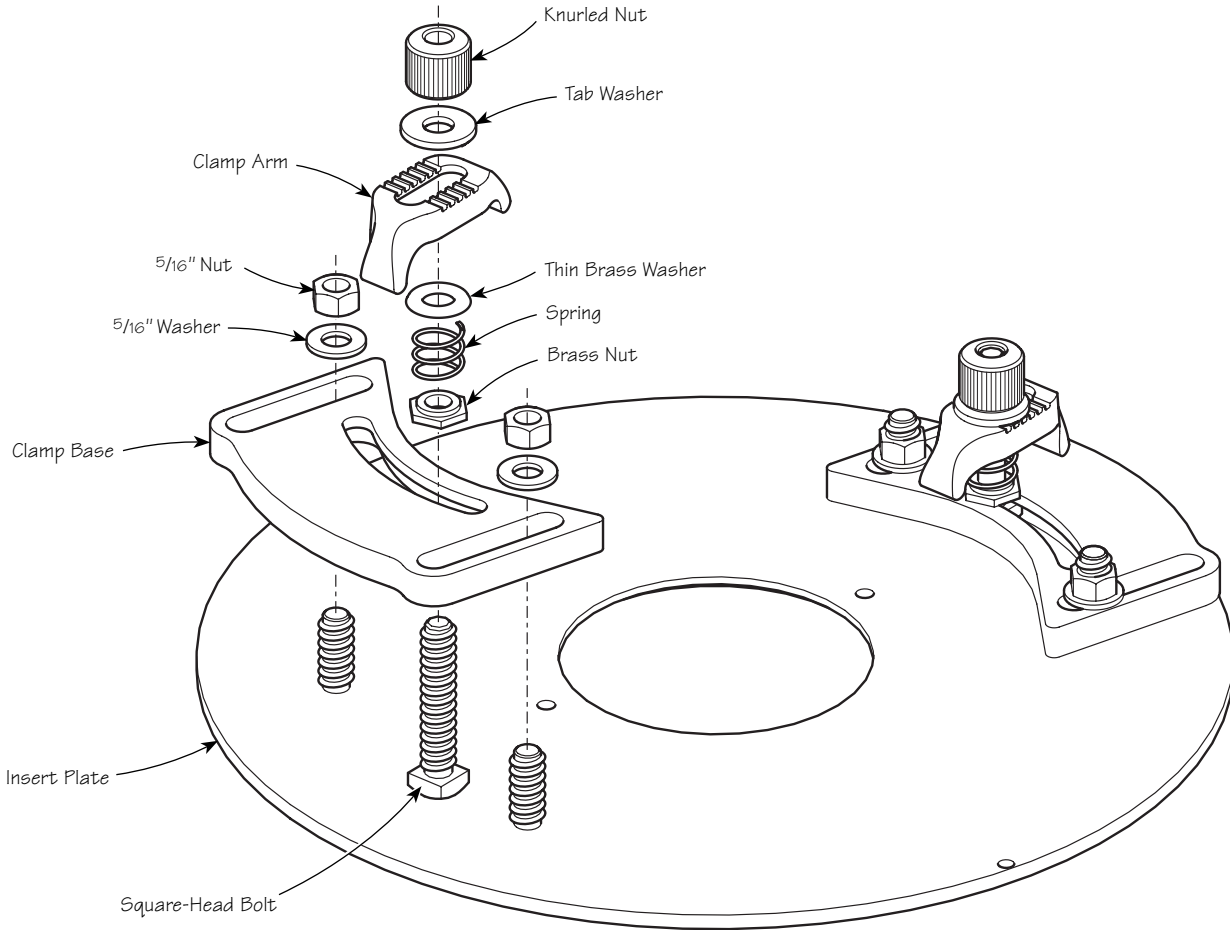
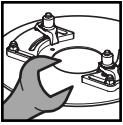

Figure 1: Components of the router table insert plate.

Assembling the Insert Plate

A 1/2" wrench (not included) will be needed to assemble the insert plate.

1. Working with the plate inverted, take the clamp bases off the insert plate by first removing the four nuts and washers from the threaded studs.

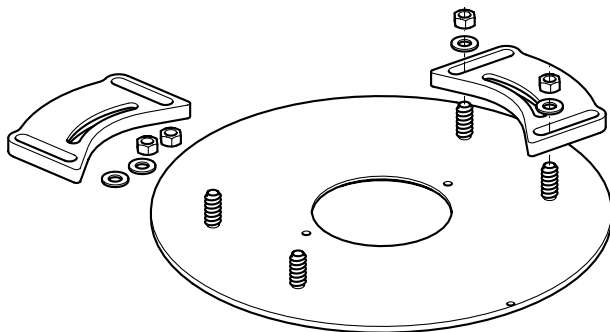

Figure 2: Removing the clamp bases.

2. Insert a square-head bolt into the curved slot of each clamp base. The head of the bolt should recess into the underside of the slot, as shown in **Figure 3**.

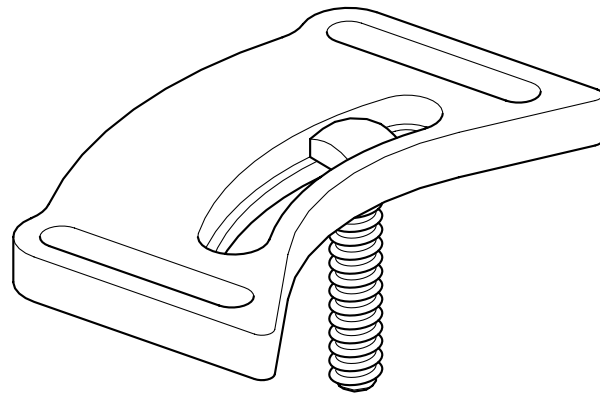
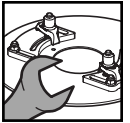

Figure 3: Inserting the square-head bolt into the clamp base.



3. Thread a brass nut (only finger tight) onto each of the bolts, orienting the hex portion against the clamp body, as shown in **Figure 4**.

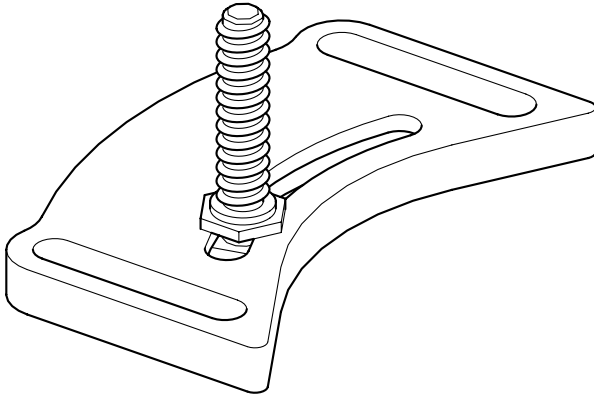

Figure 4: Threading the brass nut.

4. Place both clamp bases back onto the threaded studs and reinstall the steel washers and hex nuts removed earlier. (See **Figure 5**.) The nuts need only be finger tight, as they will be adjusted later.

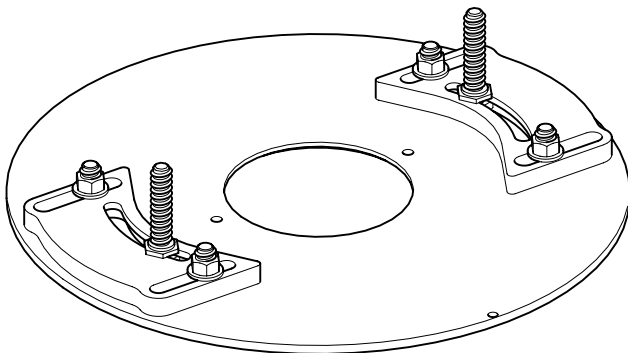

Figure 5: Reinstalling the clamp bases onto the insert plate.

5. Place the following components onto each bolt, in the order listed and oriented as shown in **Figure 6**:
 - a spring
 - a thin brass washer (sleeve toward spring)
 - a clamp arm (pads facing clamp base)
 - a tab washer (tab side facing clamp arm)
 - a knurled nut

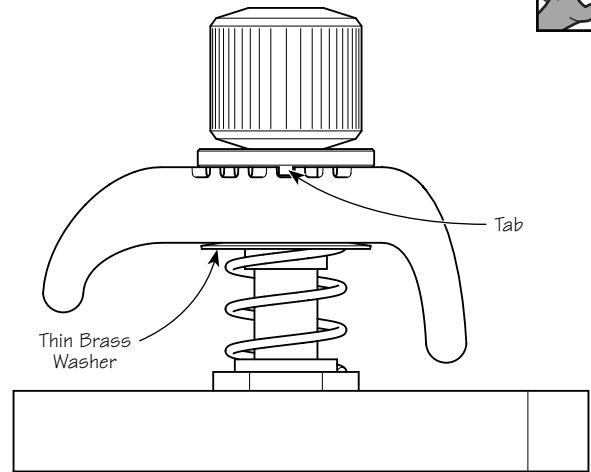
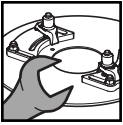

Figure 6: Adding the clamp arms. Note orientation of the thin brass washer.

This completes the assembly of the router table insert plate. For directions on how to adjust the clamps and attach a router, please refer to *Router Table Insert Plate – Usage Instructions*.



Veritas® Router Table Insert Plate
Assembly Instructions

veritas® Tools Inc.

814 Proctor Avenue 1090 Morrison Drive
Ogdensburg, New York Ottawa, Ontario
13669-2205 USA K2H 1C2 Canada
1-800-267-8735 1-800-267-8761

www.leevalley.com